

# G1045 90° Peel Fixture - Assembly Instructions

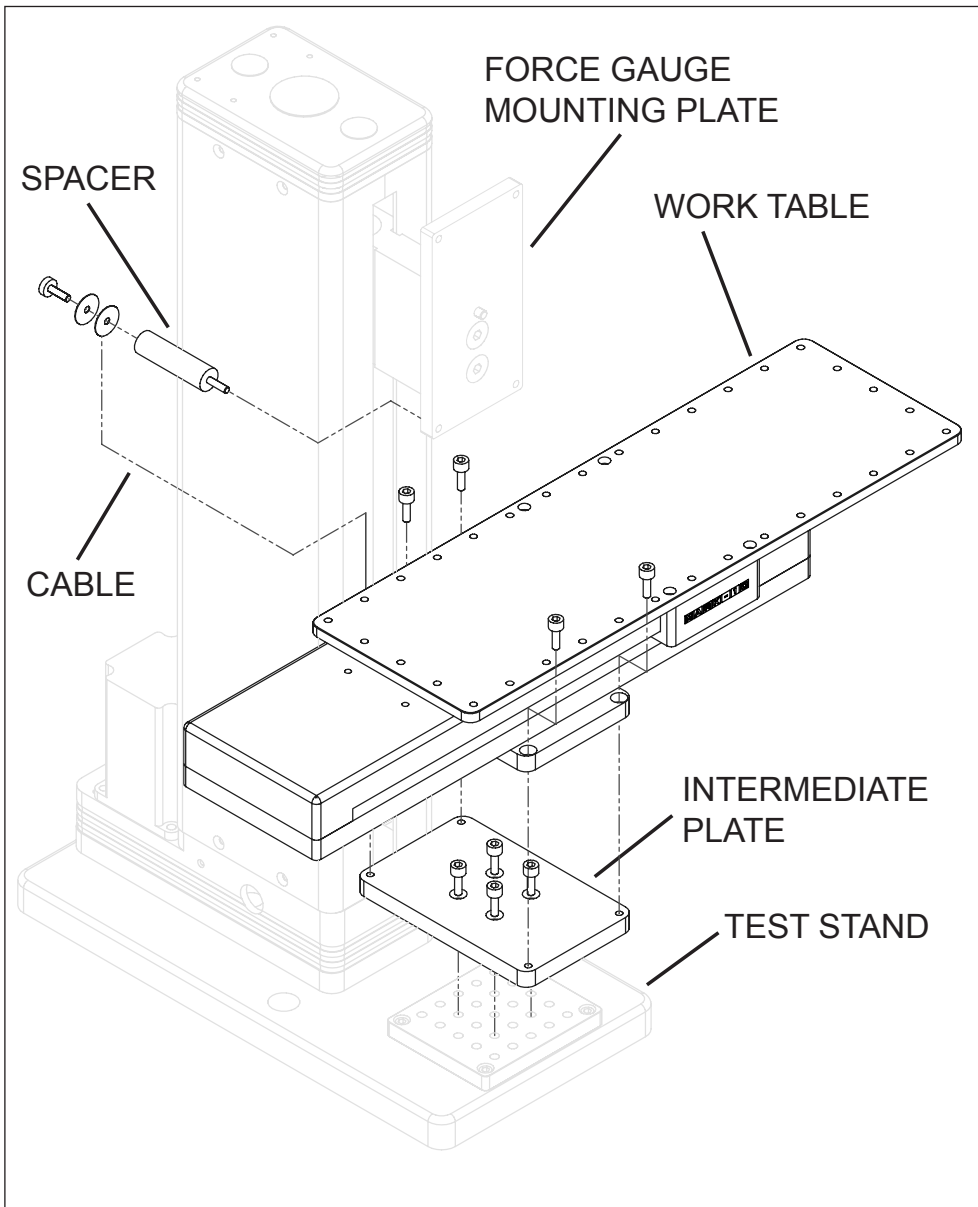

The G1045 90° peel fixture mounts to the base of a compatible Mark-10 test stand. The illustration at left depicts proper assembly. Please follow these instructions:

1. Mount the intermediate plate to the base plate of the test stand with four socket head screws.
2. Mount the fixture onto the intermediate plate with four socket head screws.
3. Remove the force gauge mounting plate from the crosshead by loosening the two flat head screws.
4. Loosely fasten the thumb screw and two washers to the spacer. Then, position the threaded male end of the spacer into the lower left hole of the force gauge mounting plate.
5. Reinstall the force gauge mounting plate, while ensuring that the spacer remains in place.
6. Install a force gauge onto the mounting plate by matching the dowel pin with the corresponding hole in the rear of its housing. Then, tighten the threaded end of the spacer into the matching hole in the rear of the force gauge.
7. Install the remaining three force gauge thumb screws.
8. Pull the cable from the rear of the fixture up to the spacer area.
9. Place the cable between the two washers and tighten the thumb screw against the rear spacer, clamping the cable in place. Tighten the thumb screw only after positioning the work table as required for the test.
6. If the G1045-1 limit switch option is used, plug the cable into the corresponding external limit connector on the test stand. Before regular use with the test stand, check to ensure the limit switch is operational by manually moving the work table horizontally to its limit of travel. Verify that the test stand stops at this point.

The fixture is now ready for use.